

ACORN
FITTINGS



Simple

Quick

Easy

Permanent

For
Plumbing
And
Heating
Systems

The permanent and professional fitting for hot and cold water plumbing and heating systems

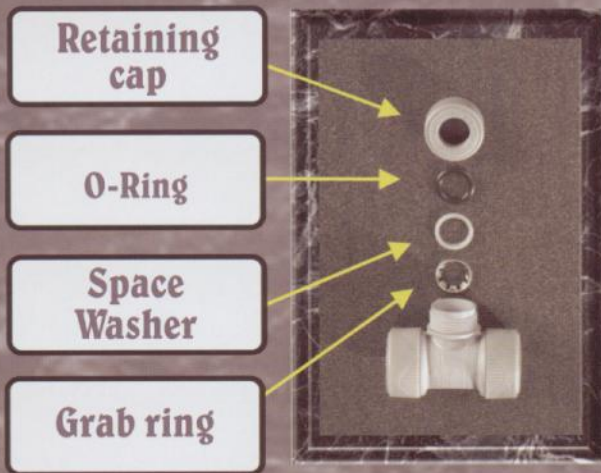

The ACORN fitting is designed to offer an alternative to soldering, threading, flaring, crimping and the expensive tools these procedures require. The ACORN fitting is easy to install and provides substantial timesaving. The ACORN fitting joins copper-tube-size (CTS) pipe that includes hard copper tube, PEX pipe, CPVC-CTS pipe and PolyB pipe, all without the need for any joining tools. The ACORN fitting can be used as a transition fitting between these types of pipes.

The ACORN fitting can also be reused by simply replacing the internal parts. The ACORN fitting selection offers most of the common fittings including male and female adapters.

The ACORN fitting has been in use around the world for over 2 decades. When installed and used correctly, this fitting system is reliable, permanent and will outlast the pipes it connects.

PART / DESCRIPTION	PART #	SIZE
Tees (Acorn x Acorn x Acorn)	AT3 AT5 AT7 AT757 AT775 AT755	3/8" 1/2" 3/4" 3/4"x1/2"x3/4" 3/4"x3/4"x1/2" 3/4"x1/2"x1/2"
Elbows (Acorn x Acorn)	AEL3 AEL5 AEL7	3/8" 1/2" 3/4"
Drop Ear Elbow (Brass Elbow with plate)	ADE5	1/2"
Straight Connectors (Acorn x Acorn)	ASC3 ASC5 ASC7	3/8" 1/2" 3/4"
Female Adapter (Acorn x FIPT)	AFPT5 AFPT7	1/2" 3/4"
Male Adapter (Acorn x MIPT)	AMPT5 AMPT7	1/2" 3/4"
Socket Reducers (Acorn x Socket)	AR53 AR75	1/2"x3/8" 3/4"x1/2"
Acorn Test Cap	APG5	1/2"

PART / DESCRIPTION	PART #	SIZE
Support Sleeve - Polybutylene	ASP3 ASP5 ASP7	3/8" 1/2" 3/4"
Cross-linked Polyethylene	ASX3 ASX5 ASX7	3/8" 1/2" 3/4"
*Each connection requires a support sleeve		
Grab Rings	AGR3 AGR5 AGR7	3/8" 1/2" 3/4"
Space Washers	ASW3 ASW5 ASW7	3/8" 1/2" 3/4"
'O' Rings	AOR3 AOR5 AOR7	3/8" 1/2" 3/4"
Blanking Caps	ABC3 ABC5 ABC7	3/8" 1/2" 3/4"

* DESIGNED EXCLUSIVELY FOR USE WITH ACORN FITTINGS

* Associate Fitting Dahl Valve	55ECD	1/2"
* Associate Fitting Dahl Valve	77EED	3/4"

Installation Instructions



Connecting an ACORN fitting

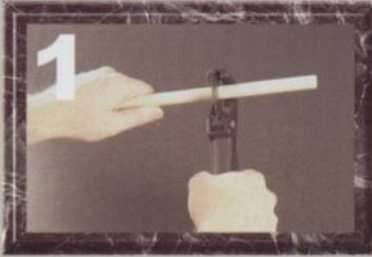

Use a cutting tool that is appropriate for the pipe (PEX, PolyB, CPVC-CTS or copper). Cut the pipe square and remove all burrs inside and out.



Insert a support sleeve into the PEX or PolyB pipe. A sleeve is not required for copper or CPVC-CTS pipe. Ensure the ACORN retaining caps are hand tightened and the internal parts are properly positioned within the fitting.



Make a mark on the pipe equal to the depth of the fitting. As you insert the pipe into the fitting, you will feel 2 points of resistance (the 'O' ring and the grab ring) before the pipe reaches the internal stop.



Hold the fitting in one hand and pull back on the pipe with the other to ensure the pipe is fully inserted and that an effective connection has been made.

Disconnecting and re-using an ACORN fitting



Unscrew the ACORN fitting retaining cap and pull the pipe out of the fitting.



Slide the 'O' ring and space washer away from the grab ring.



To remove all the internal parts from the pipe, flatten the teeth on the grab ring and slide all three internal parts off the pipe.

DO NOT RE-USE THE GRAB RING ONCE IT HAS BEEN REMOVED. THIS INTERNAL PART IS DESIGNED FOR SINGLE USE ONLY.

We recommend replacing all three internal parts when re-using the ACORN fitting.



Insert the new internal parts into the fitting starting with the grab ring, then the space washer and then the 'O' ring. Ensure the grab ring teeth are pointing to the inside of the fitting. **THE NEW PARTS MUST BE INSTALLED IN THE PROPER ORDER AND ORIENTATION OR THE FITTING WILL NOT WORK.**

Hand tighten the retaining cap. The fitting is now ready for re-use. Follow the normal installation procedures.

**The permanent and professional fitting for
hot and cold water plumbing and heating systems.**

- **CSA and NSF Certified**
- **Approved and certified for use with PEX, PB, CPVC-CTS and Copper pipes**
- **Designed for both plumbing and heating installations**
- **Eliminates soldering, crimping, threading and flaring for permanent and professional results**
- **Pressure rated from 236 psi @ 68°F to 84 psi @ 194°F**



For pricing and ordering
information, please contact:



66 Don Hillock Drive
Aurora, ON L4G 0H6
Tel: 905-727-5545 / 1-800-268-3509
Fax: 905-727-4088

Telephone: (905) 727-5545

Fax: (905) 727-4088

Toll Free: (800) 268-3509